

sunpura

Plug In Home Battery

- The world's first battery with dual-band communication (5G/2.4G) and intelligent switching for stable, reliable connectivity.
- 4 MPPT inputs, each supporting 1000Wp. Maximum charging and discharging power of 2500W, with a maximum surgepower of 3750W for off-grid use.
- Uses 314 Ah cells with up to 10,000 cycles for longer-lasting performance.
- Ecosystem integrated with smart meters and smart home devices.
- AI-driven energy management for higher efficiency and ROI.

2500W

Max. charging and discharging power

10 Years

Warranty

6500Wp

Max PV Input (PV +Micro INV)

≥10000

Cycles



sunpura Ecosystem



sunpura

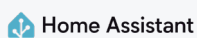

Supports Dynamic Tariffs

870+

European Power Suppliers

sunpura HOME^{AI+}

- AI-driven HEMS
- Personalized control
- Secure and reliable (GDPR compliant)

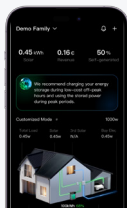

Reliable and Safe Guarding



Power Grows With Your Needs

6kWh
Up to 24 kWh

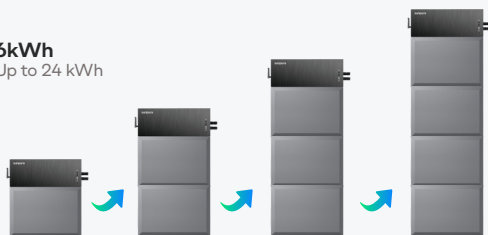

Parallel Expansion

Max - 7.5kW / 72kWh

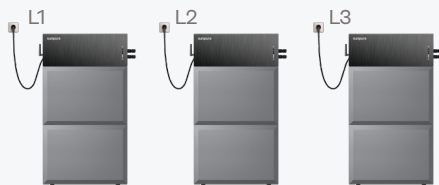

Parallel Box Expansion

Max - 15kW / 144kWh

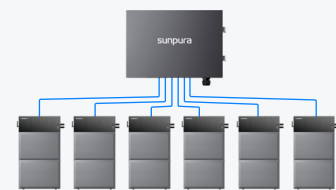

Technical Parameters

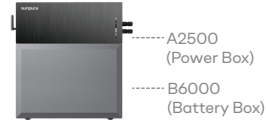

MODEL	S6000
PV TERMINAL	
Max Input Voltage	108VDC
Max Input Current	27A x 4
Max Input Power	1000Wp x 4
Operation Voltage Range	10-108VDC
MPPT Voltage Range	15-96VDC
BATTERY DATA	
Rechargeable Li-ion Battery	LiFePO ₄
Battery Nominal Voltage	19.2V
Max Charging / Discharging Current	200A
Rated Power	2500W
Cycles	≥10000 cycles 70%SOH (0.5C)
Battery Depth of Discharge (DOD)	90%
Rated Energy	6000Wh
AC INPUT (ON-GRID TERMINAL)	
Max AC Input Power	3500W
Max AC Input Current	15.3A
AC Nominal Input Voltage	L + N + PE, 220VAC / 230VAC, 50Hz
AC OUTPUT (ON-GRID TERMINAL)	
Rated AC Output Power	800W
Rated AC Output Current	3.5A
Max AC Output Power	2500W
Max AC Output Current	11.3A
AC Nominal Output Voltage	L + N + PE, 220VAC / 230VAC, 50Hz
Max AC Output apparent power	2600VA
AC OUTPUT (OFF-GRID TERMINAL)	
Max AC Output Power	2500W
Max AC Output Current	11.3A
Max AC Input Power (AC Coupled)	2500W
Max AC Bypass Output Power	2500W
Peak Output power (5s)	3750VA
AC Nominal Output Voltage	L + N + PE, 220VAC / 230VAC, 50Hz
GENERAL DATA	
Protective Class	Class I
Operating Temperature Range	-20°C to 55°C
Ingress Protection	IP65
Net Weight	A2500(Power Box): 20kg B6000(Battery Box): 60kg
Dimensions (WxHxD)	500x380x561mm (Height: A2500: 176mm/B6000: 385mm)
Overvoltage /Overcurrent /Short Circuit / Temperature Protection	Integrated
Communication Method	WIFI(5G&2.4G)/Bluetooth/RS485/LAN
Warranty	10 Years
Certificates	CE/EMC, RED, LVD, CB, ROHS, REACH, UN38.3, MSDS, Transportation of Goods, IP65, WEEE, VDE4105, EN50549, CEI 0-21, VDE0126, OVE R25, C10/11

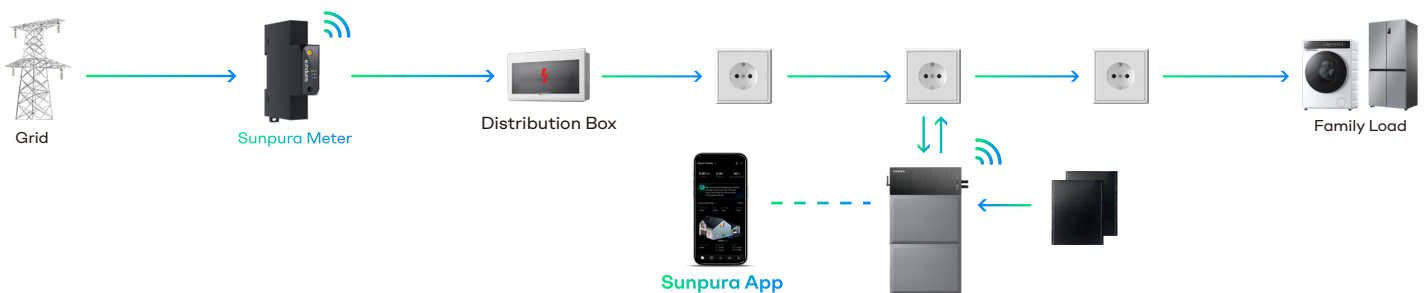

*Sunpura reserves the right to final interpretation. _202606_V1_EN



sunpura

TEL: +86 755 27210648 Email: info@sunpuraenergy.com
 Add: 4F, Tower A, Building 1, Phase 2, Gaoxinqi Industrial Park, Bao'an District, Shenzhen, China

European HQ

TEL: +49 (0) 15170691704
 Add: Rungedamm 37, 21035 Hamburg, Germany